

CONTROL CORNER
 DESCRIPTION: IPF 3/4" CRIMP TOP
 SOUTH CAROLINA STATE PLANE
 COORDINATES
 HORIZONTAL: [NAD 83 (2011)] (FEET)
 NORthing = 892,529.83
 EASTING = 1,817,093.82

UNITED STATES OF AMERICA
 UNITED STATES FOREST SERVICE
 PARCEL #148-00-00-001.000

LEGEND:

- IPF IRON PIN FOUND
- IPFS IRON PIN SET
- R/W RIGHT OF WAY
- C/L CENTER LINE
- P/L POWER/LIGHT POLE
- O/E OVERHEAD ELECTRIC
- W WATER LINE
- W WELL
- L LIGHT POLE
- S SATELLITE DISH
- P POINT

LOCATION MAP NOT TO SCALE

Doc ID: C0098550001 Type: PLT
 Recorded: 06/19/2019 at 10:55:39 AM
 Fee Amt: \$10.00 Page 1 of 1
 Instr# 201900001510
 Union County, South Carolina
 Melanie L. Lawson Clerk of Court
BK 110 pg188

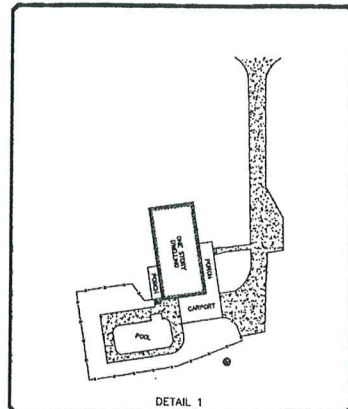

NO.	DATE	DESCRIPTION	BY
2.	6-5-19	PARCEL # ADDED TO TRACT B	JHD
1.	6-3-19	OLD PARCEL LINES ADDED	JHD

NOTES:

1. THIS PROPERTY MAY BE SUBJECT TO ADDITIONAL ROAD RIGHTS OF WAY AND UTILITY EASEMENTS.
2. SOUTH CAROLINA STATE PLANE COORDINATES DETERMINED UTILIZING SOUTH CAROLINA GEODETIC SURVEY REAL TIME NETWORK.
3. IPS 5/8" REBAR WITH CAP INSCRIBED "CANNON-DAVENPORT"
4. NO UTILITY EASEMENTS OR RIGHTS OF WAY WERE SURVEYED OR LOCATED ON THIS PLAT OF SURVEY
5. PARCEL #148-00-00-005.000, 148-00-00-011.00, 148-00-00-008.000
6. NO PHYSICAL SURVEYING ON 3 JUNE 2019; OLD PARCEL LINES ADDED ONLY.
7. NO PHYSICAL SURVEYING ON 5 JUNE 2019; PARCEL NUMBER ADDED TO TRACT B ONLY

I HEREBY STATE THAT TO THE BEST OF MY KNOWLEDGE, INFORMATION AND BELIEF, THE SURVEY SHOWN HEREIN WAS MADE IN ACCORDANCE WITH THE REQUIREMENTS OF THE MINIMUM STANDARDS MANUAL FOR THE PRACTICE OF LAND SURVEYING IN SOUTH CAROLINA, AND MEETS OR EXCEEDS THE REQUIREMENTS FOR A CLASS B SURVEY AS SPECIFIED THEREIN; ALSO THERE ARE NO ENCROACHMENTS OR PROJECTIONS OTHER THAN SHOWN.

STATE OF SOUTH CAROLINA
 UNION COUNTY

SURVEY FOR
TRACT A
FIRST FINANCIAL BANK
TRACT B
BRADLEY KENDRICK

CANNON-DAVENPORT SURVEYING, INC.
 Professional Land Surveyors
 7216 SC Highway 56
 Kinards, SC 29555
 (864) 505-9784 (Cellular)
 E-MAIL: davenport@firstfinancial.com

SEED BOX 278 @ B13
 PLAT CABINET A334 @ 105
 TAX MAP SEE NOTE 5
 PARTY CHIEF JHD
 DRAWN JHD
 DATE 5 JUNE 2019
 DWG. NO. 219032.AJMS

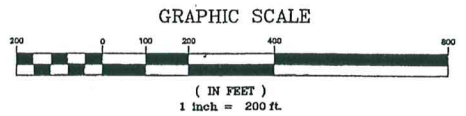
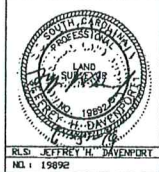

MYRON K. PRATHER
 DB 234 @ 258
 PC 846 @ 21
 PARCEL #148-00-00-004.000

TRACT A
 34.13 AC GROSS
 1.28 AC ROAD R/W
 32.85 AC NET

TRACT B
 33.00 AC GROSS
 2.15 AC ROAD R/W
 30.85 AC NET

PARCEL 148-00-00-005

DELTA ROAD / S-44-B7
 50' RIGHT OF WAY

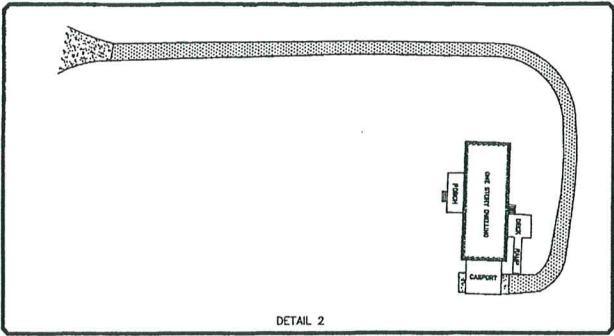

MAGNAIL WITH WASHER SET @ CENTERLINE INTERSECTION

MAGNAIL WITH WASHER SET @ CENTERLINE

MAGNAIL FOUND @ CENTERLINE

SEE DETAIL 1

SEE DETAIL 2

SEE DETAIL 1

SEE DETAIL 2

IPF 1" REBAR

IPF 1" OPEN TOP @ 200.21'

IPF 3/4" CRIMP TOP @ 25.00'

IPF 5/8" REBAR WITH CAP @ 1239.13'

IPF 5/8" REBAR WITH CAP @ 1290.58'

IPF 5/8" REBAR WITH CAP @ 217.35'

IPF 1" REBAR (BENT)

IPF 5/8" REBAR WITH CAP

IPF 1 1/2" PIPE WITH USFS ALUMINUM DISK

IPF 5/8" REBAR WITH CAP

IPF 5/8" REBAR WITH CAP

IPF 5/8" REBAR WITH CAP

IPF 5/8" REBAR WITH CAP

IPF 5/8" REBAR WITH CAP

IPF 5/8" REBAR WITH CAP

IPF 5/8" REBAR WITH CAP

IPF 5/8" REBAR WITH CAP

IPF 5/8" REBAR WITH CAP

IPF 5/8" REBAR WITH CAP

IPF 5/8" REBAR WITH CAP

IPF 5/8" REBAR WITH CAP

IPF 5/8" REBAR WITH CAP

IPF 5/8" REBAR WITH CAP

IPF 5/8" REBAR WITH CAP

IPF 5/8" REBAR WITH CAP

IPF 5/8" REBAR WITH CAP

IPF 5/8" REBAR WITH CAP

IPF 5/8" REBAR WITH CAP

IPF 5/8" REBAR WITH CAP

IPF 5/8" REBAR WITH CAP

IPF 5/8" REBAR WITH CAP

IPF 5/8" REBAR WITH CAP

IPF 5/8" REBAR WITH CAP

IPF 5/8" REBAR WITH CAP

IPF 5/8" REBAR WITH CAP

IPF 5/8" REBAR WITH CAP

IPF 5/8" REBAR WITH CAP

IPF 5/8" REBAR WITH CAP

IPF 5/8" REBAR WITH CAP

IPF 5/8" REBAR WITH CAP

IPF 5/8" REBAR WITH CAP

IPF 5/8" REBAR WITH CAP

IPF 5/8" REBAR WITH CAP

IPF 5/8" REBAR WITH CAP

IPF 5/8" REBAR WITH CAP

IPF 5/8" REBAR WITH CAP

IPF 5/8" REBAR WITH CAP

IPF 5/8" REBAR WITH CAP

IPF 5/8" REBAR WITH CAP

IPF 5/8" REBAR WITH CAP

IPF 5/8" REBAR WITH CAP

IPF 5/8" REBAR WITH CAP

IPF 5/8" REBAR WITH CAP

IPF 5/8" REBAR WITH CAP

IPF 5/8" REBAR WITH CAP

IPF 5/8" REBAR WITH CAP

IPF 5/8" REBAR WITH CAP

IPF 5/8" REBAR WITH CAP

IPF 5/8" REBAR WITH CAP

IPF 5/8" REBAR WITH CAP

IPF 5/8" REBAR WITH CAP

IPF 5/8" REBAR WITH CAP

IPF 5/8" REBAR WITH CAP

IPF 5/8" REBAR WITH CAP

IPF 5/8" REBAR WITH CAP

IPF 5/8" REBAR WITH CAP

IPF 5/8" REBAR WITH CAP

IPF 5/8" REBAR WITH CAP

IPF 5/8" REBAR WITH CAP

IPF 5/8" REBAR WITH CAP

IPF 5/8" REBAR WITH CAP

IPF 5/8" REBAR WITH CAP

IPF 5/8" REBAR WITH CAP

IPF 5/8" REBAR WITH CAP

IPF 5/8" REBAR WITH CAP

IPF 5/8" REBAR WITH CAP

IPF 5/8" REBAR WITH CAP

IPF 5/8" REBAR WITH CAP

IPF 5/8" REBAR WITH CAP

IPF 5/8" REBAR WITH CAP

IPF 5/8" REBAR WITH CAP

IPF 5/8" REBAR WITH CAP

IPF 5/8" REBAR WITH CAP

IPF 5/8" REBAR WITH CAP

IPF 5/8" REBAR WITH CAP

IPF 5/8" REBAR WITH CAP

IPF 5/8" REBAR WITH CAP

IPF 5/8" REBAR WITH CAP

IPF 5/8" REBAR WITH CAP

IPF 5/8" REBAR WITH CAP

IPF 5/8" REBAR WITH CAP

IPF 5/8" REBAR WITH CAP

IPF 5/8" REBAR WITH CAP

IPF 5/8" REBAR WITH CAP

IPF 5/8" REBAR WITH CAP

IPF 5/8" REBAR WITH CAP

IPF 5/8" REBAR WITH CAP

IPF 5/8" REBAR WITH CAP

IPF 5/8" REBAR WITH CAP

IPF 5/8" REBAR WITH CAP

IPF 5/8" REBAR WITH CAP

IPF 5/8" REBAR WITH CAP

IPF 5/8" REBAR WITH CAP

IPF 5/8" REBAR WITH CAP

IPF 5/8" REBAR WITH CAP

IPF 5/8" REBAR WITH CAP

IPF 5/8" REBAR WITH CAP

IPF 5/8" REBAR WITH CAP

IPF 5/8" REBAR WITH CAP

IPF 5/8" REBAR WITH CAP

IPF 5/8" REBAR WITH CAP

IPF 5/8" REBAR WITH CAP

IPF 5/8" REBAR WITH CAP

IPF 5/8" REBAR WITH CAP

IPF 5/8" REBAR WITH CAP

IPF 5/8" REBAR WITH CAP

IPF 5/8" REBAR WITH CAP

IPF 5/8" REBAR WITH CAP

IPF 5/8" REBAR WITH CAP

IPF 5/8" REBAR WITH CAP

IPF 5/8" REBAR WITH CAP

IPF 5/8" REBAR WITH CAP

IPF 5/8" REBAR WITH CAP

IPF 5/8" REBAR WITH CAP

IPF 5/8" REBAR WITH CAP

IPF 5/8" REBAR WITH CAP

IPF 5/8" REBAR WITH CAP

IPF 5/8" REBAR WITH CAP

IPF 5/8" REBAR WITH CAP

IPF 5/8" REBAR WITH CAP

IPF 5/8" REBAR WITH CAP

IPF 5/8" REBAR WITH CAP

IPF 5/8" REBAR WITH CAP

IPF 5/8" REBAR WITH CAP

IPF 5/8" REBAR WITH CAP

IPF 5/8" REBAR WITH CAP

IPF 5/8" REBAR WITH CAP

IPF 5/8" REBAR WITH CAP

IPF 5/8" REBAR WITH CAP

IPF 5/8" REBAR WITH CAP

IPF 5/8" REBAR WITH CAP

IPF 5/8" REBAR WITH CAP

IPF 5/8" REBAR WITH CAP

IPF 5/8" REBAR WITH CAP

IPF 5/8" REBAR WITH CAP

IPF 5/8" REBAR WITH CAP

IPF 5/8" REBAR WITH CAP

IPF 5/8" REBAR WITH CAP

IPF 5/8" REBAR WITH CAP

IPF 5/8" REBAR WITH CAP

IPF 5/8" REBAR WITH CAP

IPF 5/8" REBAR WITH CAP

IPF 5/8" REBAR WITH CAP

IPF 5/8" REBAR WITH CAP

IPF 5/8" REBAR WITH CAP

IPF 5/8" REBAR WITH CAP

IPF 5/8" REBAR WITH CAP

IPF 5/8" REBAR WITH CAP

IPF 5/8" REBAR WITH CAP

IPF 5/8" REBAR WITH CAP

IPF 5/8" REBAR WITH CAP

IPF 5/8" REBAR WITH CAP

IPF 5/8" REBAR WITH CAP

IPF 5/8" REBAR WITH CAP

IPF 5/8" REBAR WITH CAP

IPF 5/8" REBAR WITH CAP

IPF 5/8" REBAR WITH CAP

IPF 5/8" REBAR WITH CAP

IPF 5/8" REBAR WITH CAP

IPF 5/8" REBAR WITH CAP

IPF 5/8" REBAR WITH CAP

IPF 5/8" REBAR WITH CAP

IPF 5/8" REBAR WITH CAP

IPF 5/8" REBAR WITH CAP

IPF 5/8" REBAR WITH CAP

IPF 5/8" REBAR WITH CAP

IPF 5/8" REBAR WITH CAP

IPF 5/8" REBAR WITH CAP

IPF 5/8" REBAR WITH CAP

IPF 5/8" REBAR WITH CAP

IPF 5/8" REBAR WITH CAP

IPF 5/8" REBAR WITH CAP

IPF 5/8" REBAR WITH CAP

IPF 5/8" REBAR WITH CAP

IPF 5/8" REBAR WITH CAP

IPF 5/8" REBAR WITH CAP

IPF 5/8" REBAR WITH CAP

IPF 5/8" REBAR WITH CAP

IPF 5/8" REBAR WITH CAP

IPF 5/8" REBAR WITH CAP

IPF 5/8" REBAR WITH CAP

IPF 5/8" REBAR WITH CAP

IPF 5/8" REBAR WITH CAP

IPF 5/8" REBAR WITH CAP

IPF 5/8" REBAR WITH CAP

IPF 5/8" REBAR WITH CAP

IPF 5/8" REBAR WITH CAP

IPF 5/8" REBAR WITH CAP

IPF 5/8" REBAR WITH CAP

IPF 5/8" REBAR WITH CAP

IPF 5/8" REBAR WITH CAP