

ROGERS, A.P.

PRU - LUMBER RIVER, NC

Date: 29-Jan-04

District: LUMBERTON
 Tract No: 18060805
 Compartment: 4
 County: COLUMBUS
 State: NC
 Acreage: 76

STAND INFORMATION

Stand/Comp	Description	Year	Book	Acres
31-	4 LBCFPY3L	1990	74.	3
32-	4 UDDBONNL	0	1.	7
				Total 76.

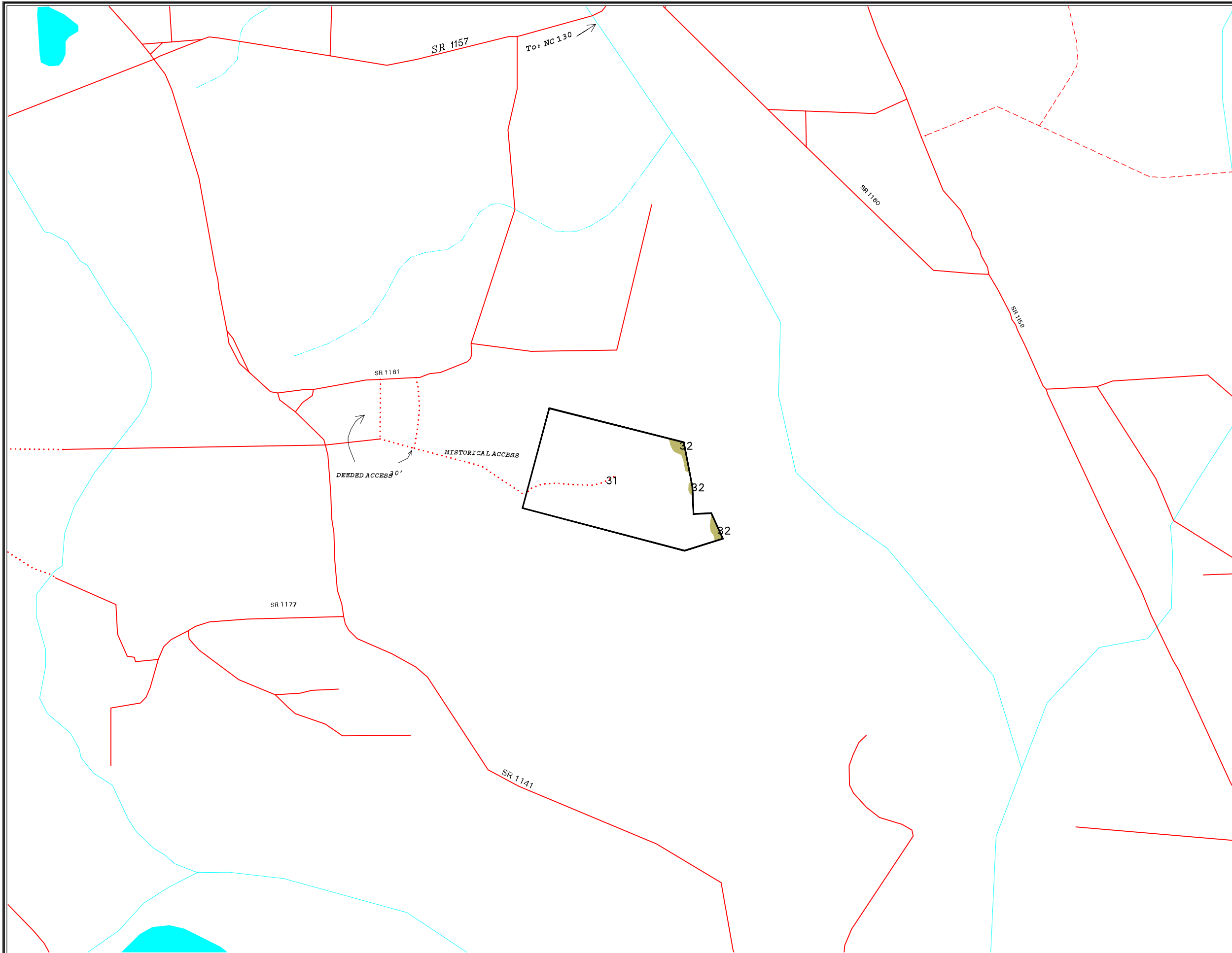

LEGEND

- Interstate/US Highway
- State Highway
- County/City Road
- - - Company Grade Road
- · · · · Woods Trail
- Railroad
- Perennial Stream
- - - Intermittent Stream
- Utility R/W
- County Boundary
- Compartment Boundary
- Compartment
- Undefined Area
- Outpiece
- Water Body

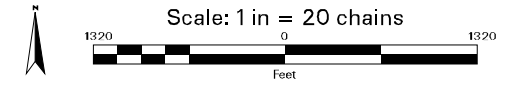

*This map is for planning purposes only.
 Data is in Albers Equal Area projection.*