

**TRACT #32
CROSSING LINES
143 ACRES**

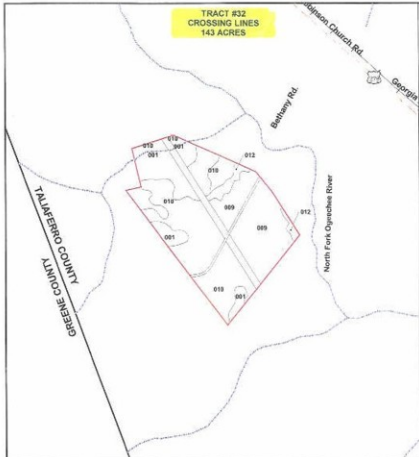

1300 0 1300 Feet

1 INCH = 20 CHAINS

| Stand no. | Acres | Type | Species | Total acs. |
|-----------|-------|-----------------|-----------|------------|
| 001 | 11 | Normal Red | Hard Red | 1100 |
| 009 | 42 | Plantation | Loblolly | 1000 |
| 010 | 1.92 | Slower | | 0 |
| 012 | 11 | Normal Red/Pine | Mixed Red | 0 |

PIEDMONT INVESTORS



L.L.C.



**SOUTHEAST REGION
COMPARTMENT 7353443
216 ACRES**

TALIAFERRO COUNTY GEORGIA